

DOUBLE ROD SERIES (LIGHT PERFORMANCE)

Material:

Galvanized steel

Riveted pivots and rod:

Galvanized steel

Swinging pivot:

Galvanized steel

Handles:

Red polyurethane resistant to oils, grease and other chemical agents.

Performance:

The tool comes with a double bar with hooking bracket and nuts.

In addition to the standard length of the U rods, a variety of other lengths are given on page 57.

Therefore, when ordering, indicate:

T4 = Tool with Standard Double Threaded Rod and hooking bracket

T40 = Tool without double Threaded rod, **which is to be ordered separately** (see page 57)

Features and applications:

The tools of this series ensure a perfect closing of lids.

The support base is perpendicular to the force line of action.

In the closed position, the control lever is perpendicular to the support base.

A special grease is placed between two contacting surfaces during assembly.

FORM T4

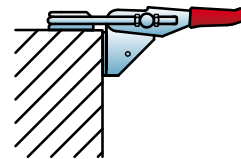
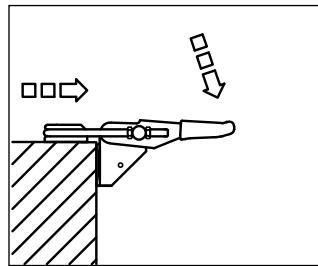
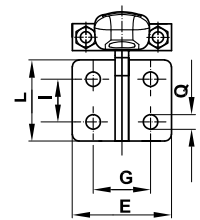
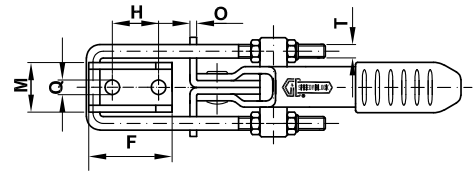
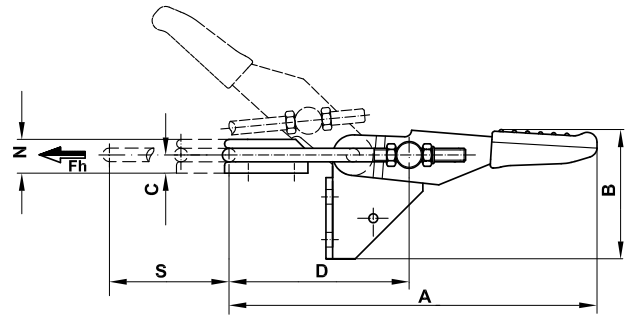

T4

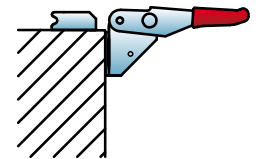

T40

Code	Description	A	B	C	D	E	F	G	H	I	L	M	N	O	Q	S	T	Fh (daN)	gr.
AL560	160/T4	104	40	5	49÷58	35	25,5	22	14,3	13	26	14	10	2	4,3	23,5÷27,5	M4	160	95
AL565	320/T4	160	57,5	8	75÷95	44	37	25,5	20,5	19	36	22	15	3	6,5	40÷46	M6	320	295
AL570	700/T4	233	82	13	98÷122	54	48,5	36,5	27	32	52	26	23	3,5	8,5	50÷58	M8	750	655

