

HEAVY-DUTY PNEUMATIC SERIES

Material:

Base made of black varnished spheroidal cast iron;
Lever in galvanized steel;
Hardened and ground pivots.

Cylinder:

ISO Magnetic Standards.
Maximum operating pressure 10 bar.
Maximum operating temperature 80°C
Model AU470 is the reed switch for detecting the position to be ordered separately.

Features and applications:

These tools are designed to withstand high loads and a high number of operations.

We recommend using a filter-reducer-lubricator group for a long and smooth operation of the cylinder, while for a long duration of the mechanical components we recommend using the flow regulators found on the head for calibrating the speed of the motions desired, starting from a low speed and gradually increasing this speed.

A special grease is placed between two contacting surfaces during assembly.

FORM EPM

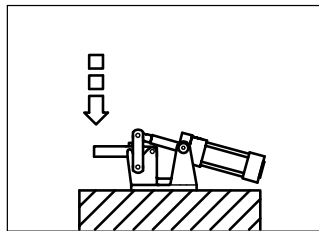
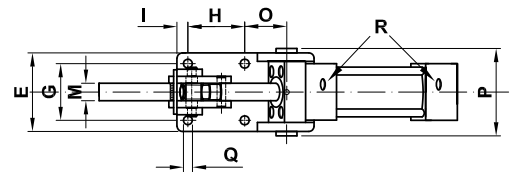
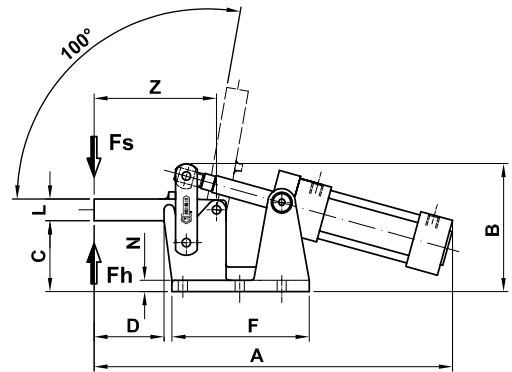

| Code | Description | A | B | C | D | E | F | G | H | I | L | M | N | O | P | Q | R | Z | Fh (daN) | Fs (daN) | gr. |
|-------|-------------|-----|-------|----|-----|-----|-----|----|----|------|----|----|----|----|-----|------|------|-----|----------|----------|------|
| A0600 | 1000/EPM | 410 | 146,5 | 80 | 80 | 90 | 155 | 65 | 65 | 12,5 | 25 | 20 | 13 | 48 | 102 | 10,5 | 1/4" | 140 | 1000 | 320 | 6500 |
| A0620 | 2000/EPM | 487 | 171,5 | 90 | 100 | 100 | 176 | 70 | 70 | 15 | 35 | 20 | 13 | 56 | 112 | 10,5 | 3/8" | 172 | 2000 | 380 | 9500 |

