

VERTICAL SERIES WITH ANTI-RELEASE LEVER AND EXTENDED CLAMPING LEVER

Material:

Galvanized steel

Riveted pivots:

Galvanized steel

Supporting bushes:

Hardened and ground steel

Handles:

Red polyurethane resistant to oils, grease and other chemical agents.

Performance:

Form ELS with extended clamping lever and folded base.

Form FLS with extended clamping lever and straight base.

Spindles:

To be ordered separately (see Accessories on page 87).

Extensions:

The models are supplied with AP6 and AP8 extension as per the drawing and with two flanged washers (see Accessories on page 90).

Features and applications:

The main features of this series are the special anti-release lever and the special extension of the locking arm to facilitate the specific use in control templates; these tools are designed to prevent the operator's fingers from being crushed by the levers when opening. During the closing, the clamping lever is guided laterally to ensure greater stability against possible transverse stresses.

A special grease is placed between two contacting surfaces during assembly.

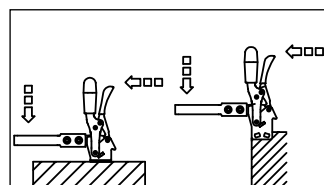

FORM ELS



PATENTED

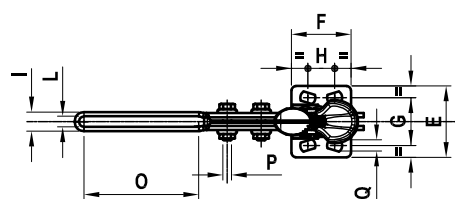
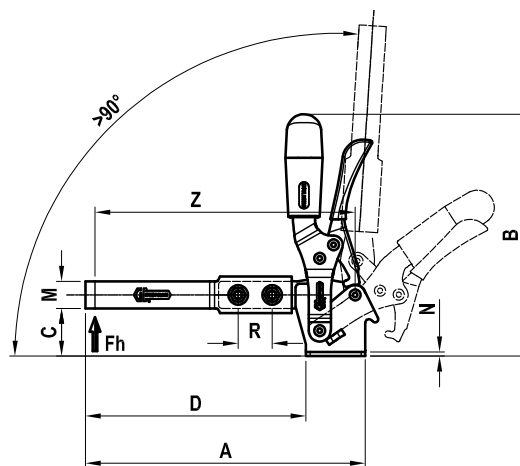

FORM FLS



PATENTED

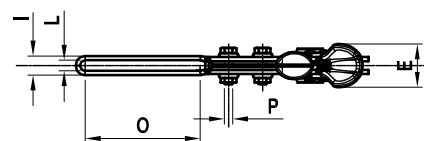
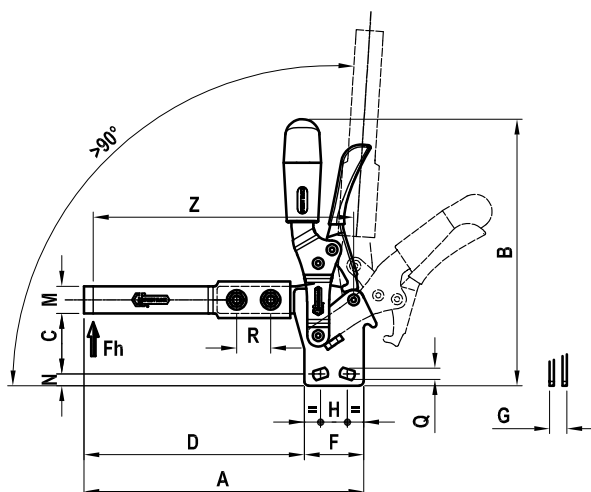

Code	Description	A	B	C	D	E	F	G	H	I	L	M	N	O	P	Q	R	Z	Fh daN	gr.
AA587	130/ELS	164	142	28	129	42	35	27÷29	12,5÷19	11,3	6,3	16	2,5	67,5	M6	5,6	20	152	50	375
AA589	130/FLS	164	156	35÷36	129	25,5	35	10	12,5÷19	11,3	6,3	16	6,5÷7,5	67,5	M6	5,6	20	152	50	375
AA595	230/ELS	198	168	33,5	155	45	43	32	19,5	14,2	8,2	18	3	71,5	M8	6,7	26	182	100	545
AA597	230/FLS	198	183	41,5	155	30	43	12	19,5	14,2	8,2	18	6,5	71,5	M8	6,7	26	182	100	545