

## FORM BL

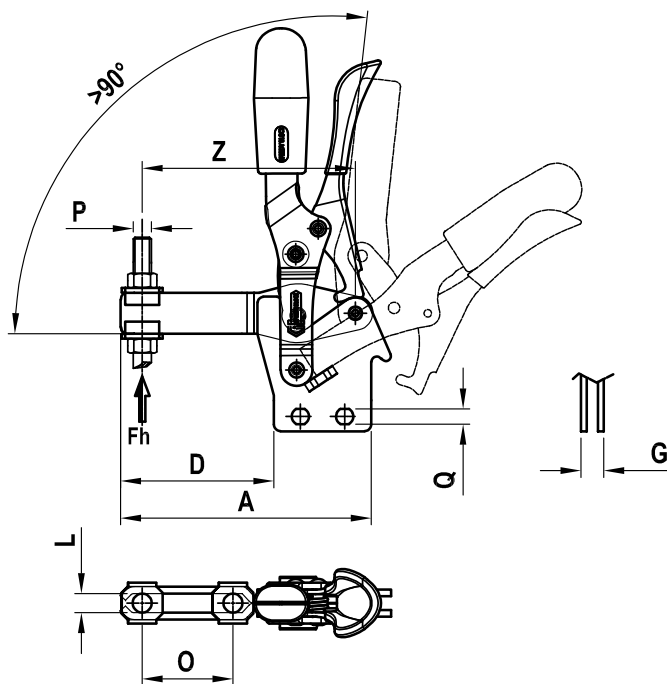

PATENTED



### VERTICAL SERIES WITH STRAIGHT BASE AND ANTI-RELEASE LEVER

Some sizes of this series are also produced in stainless steel and are shown below in red.

**Material:**

Galvanized steel or **AISI 304 stainless steel**

**Riveted pivots:**

Galvanized steel or **AISI 304 stainless steel**

**Supporting bushes:**

Hardened and ground steel.

**Handles:**

Red polyurethane resistant to oils, grease and other chemical agents.

**Performance:**

Form BL and **form BLX** with open clamping lever and two flanged washers.

Form FL and **form FLX** with full clamping lever and bolt retainers to be welded in the desired position and angle.

**Spindles:**

To be ordered separately (see Accessories on page 87).

**Features and applications:**

The main feature of this series is the special anti-release lever with the purpose of avoiding any accidental openings caused by vibrations; and to block the tool in the open position; these tools are designed to prevent the operator's fingers from being crushed by the levers when opening. During the closing, the clamping lever is guided laterally to ensure greater stability against possible transverse stresses. A special grease is placed between two contacting surfaces during assembly.

## FORM FL



PATENTED

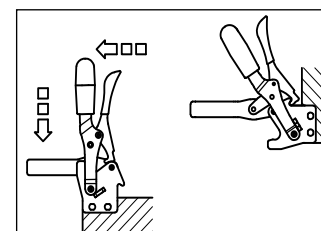
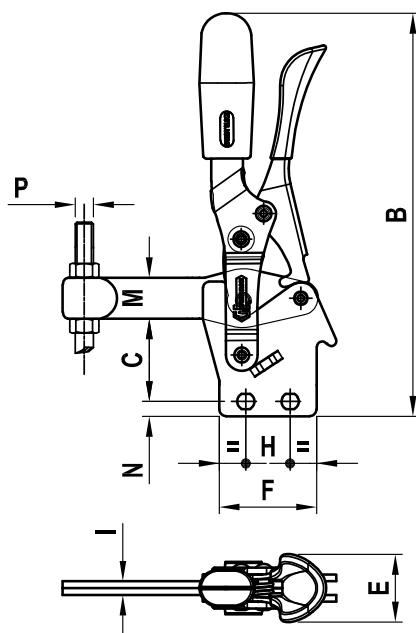

Code	Description	Stainless steel Code	Description	A	B	C	D	E	F	G	H	I	L	M	N	O	P	Q	Z	Fh (daN)	gr.
AA584	130/BL	AS202	130/BLX	85	156	35-36	50	25,5	35	10	12,5÷19		6,2	16	6,5÷7,5	28	M6	5,6	71	105	275
AA588	130/FL	AS206	130/FLX	86	156	35-36	51	25,5	35	10	12,5÷19	5		16	6,5÷7,5		M6	5,6		105	280
AA592	230/BL	AS212	230/BLX	110,5	183	41,5	67,5	30	43	12	18÷21		8,5	18	6,5	40	M8	6,7	94	200	380
AA596	230/FL	AS216	230/FLX	112	183	41,5	69	30	43	12	18÷21	6		18	6,5		M8	6,7		200	390