

# PNEUMATIC SERIES

## HEAVY PNEUMATIC SERIES

**Material:** Base made of black varnished spheroidal cast iron  
Lever in galvanized steel;  
Hardened and ground pivots.

**Cylinder:** ISO Magnetic Standards  
Maximum operating pressure 10 bar.  
Maximum operating temperature 80°C  
Model AU470 is the reed switch for detecting the position (See Accessories on page 76) to be ordered separately.

**Features and applications:**

These tools are designed to withstand high loads and a high number of operations.

We recommend using a filter-reducer-lubricator group for a long and smooth operation of the cylinder, while for a long duration of the mechanical components we recommend using the flow regulators found on the head for calibrating the speed of the motions desired, starting from a low speed and gradually increasing this speed.

A special grease is placed between two contacting surfaces during assembly.

### FORM EPM

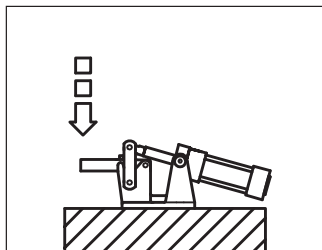
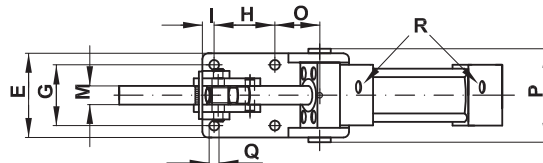
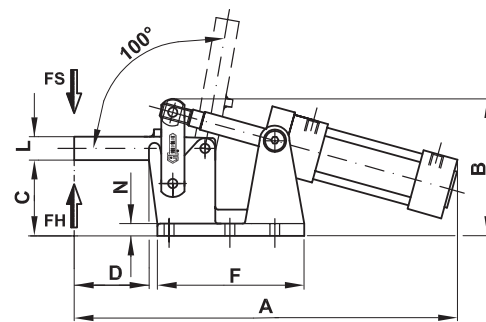

Code	Description	A	B	C	D	E	F	G	H	I	L	M	N	O	P	Q	R	Fh (daN)	Fs (daN)	gr. 
AO600	1000/EPM	410	146.5	80	80	90	155	65	65	12.5	25	20	13	48	102	10.5	1/4"	1000	320	6500
AO620	2000/EPM	487	171.5	90	100	100	176	70	70	15	35	20	13	56	112	10.5	3/8"	2000	380	9500

