

VERTICAL ROTATIONAL SERIES

VERTICAL SERIES FOR HIGH TEMPERATURES

Material: Phosphated steel

Riveted pivots: Phosphated steel

Supporting bushes: Hardened and ground steel.

Performance: With eye bolt clamping lever for inserting the spindle.

Spindles: To be ordered separately (see Accessories on page 76)

Features and applications:

The tools of this series are generally used in rotational forging, as it is able to operate at high temperatures (240-300°C).

This is made possible thanks to their finish, the interposition of special copper grease between the parts and appropriate tolerances between the couplings.

FORM ER

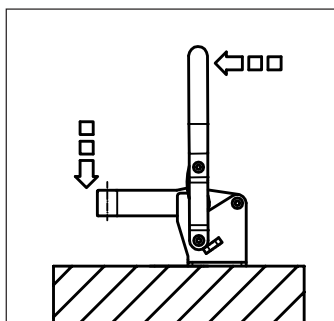
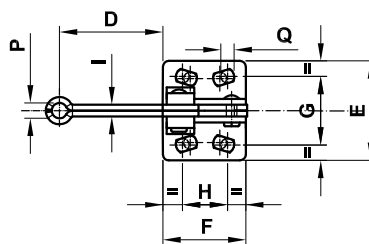
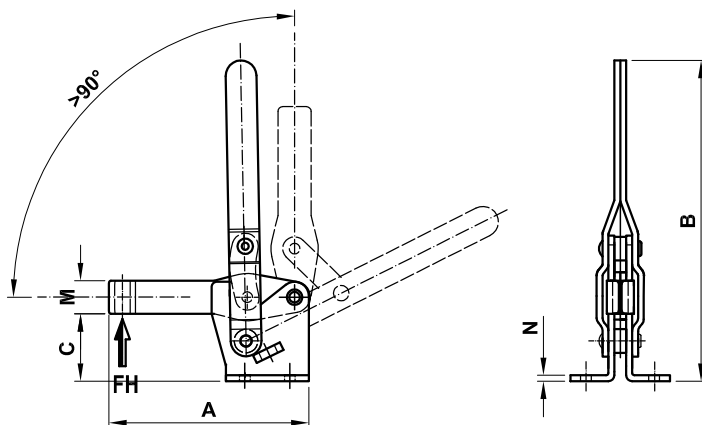

| Code | Description | A | B | C | D | E | F | G | H | I | M | N | P | Q | Fh1 (daN) | gr. |
|-------|-------------|-----|-----|------|----|------|----|-------|---------|---|----|-----|------|-----|-----------|---------|
| AR530 | 130/ER | 85 | 136 | 28 | 44 | 42 | 35 | 27-29 | 12.5-19 | 5 | 16 | 2.5 | 6.5 | 5.6 | 160 | 210 |
| AR540 | 230/ER | 110 | 164 | 33.5 | 60 | 45 | 43 | 32 | 19-20 | 6 | 18 | 3 | 8 | 6.7 | 200 | 330 |
| AR550 | 330/ER | 128 | 189 | 43 | 69 | 68.5 | 50 | 45-46 | 29-32 | 7 | 22 | 3.5 | 10.5 | 8.5 | 240 | 519 |