

LATCH SERIES

DOUBLE ROD SERIES (LIGHT PERFORMANCE)

Material: Galvanized steel
Riveted pivots and rod: Galvanized steel

Swinging pivot: Galvanized steel
Handles: Red polyurethane resistant to oils, grease and other chemical agents.

Performance: The tool comes with a double bar with hooking bracket and nuts.
 In addition to the standard length of the U rods, a variety of other lengths are given on page 55.

Therefore, when ordering, indicate:

T4 = Tool with Standard Double Threaded Rod and hooking bracket

T40 = Tool without double Threaded rod, **which is to be ordered separately** (see page 55)

Features and applications: The tools of this series ensure a perfect closing of lids.

The support base is perpendicular to the force line of action.

In the closed position, the control lever is perpendicular to the support base.

A special grease is placed between two contacting surfaces during assembly.

FORM T4

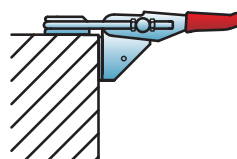
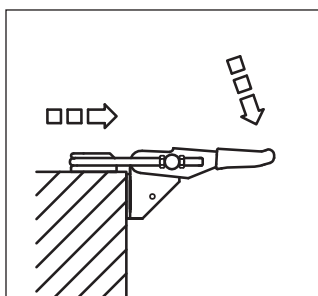
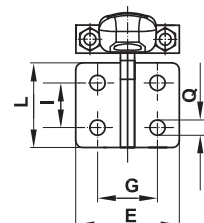
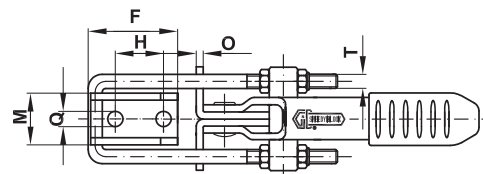
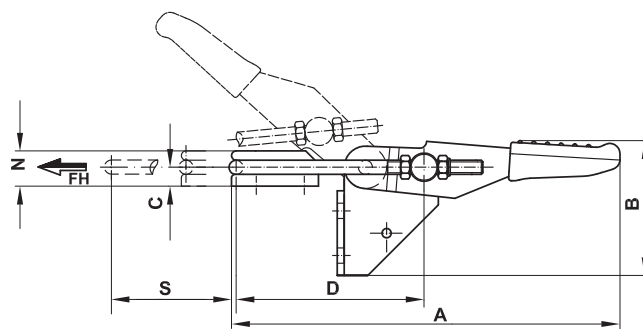
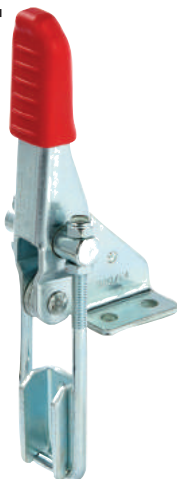

T4

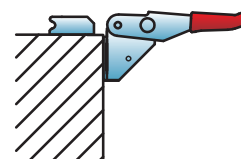

T40

Code	Description	A	B	C	D	E	F	G	H	I	L	M	N	O	Q	S	T	Fh (daN)	gr- ⚖️
AL560	160/T4	99	40	5	48-58	35	25.5	22	14.3	13	26	14	10	2	4.3	32	M4	160	95
AL565	320/T4	152	57.5	8	75-95	44	37	25.5	20.5	19	36	22	15	3	6.5	53	M6	320	295
AL570	700/T4	225	82	13	98-122	54	48.5	36.5	27	32	52	26	23	3.5	8.5	64	M8	750	655

