

FORM AS

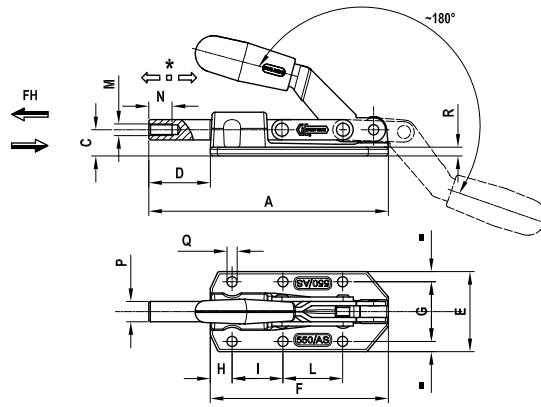

PUSH AND PULL STRAIGHT-LINE ACTION SERIES

Material: Galvanized steel
Riveted pivots, push bar and control lever: Galvanized steel
Basic clamp body: Black varnished brass for size 70; hot forged steel and painted black for the other sizes.
Handles: Red polyurethane; resistant to oils, grease and other chemical agents.
Spindles: To be ordered separately (see Accessories on page 76).
Features and applications:
 The tools of this series can either be pushed or pulled.
 A special grease is placed between two contacting surfaces during assembly.
 This pneumatic actuated series is found on page 75.

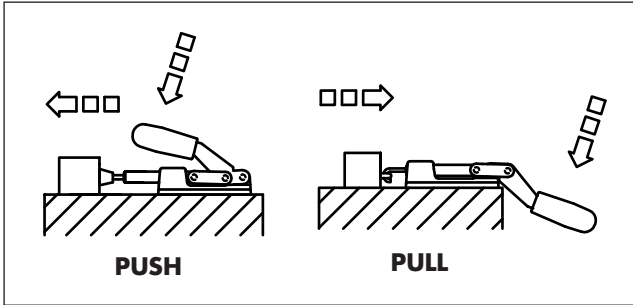

Code	Description	A	B	C	D	E	F	G	H	I	L	M	N	P	Q	R	*	Fh (daN)	gr.
AG070	70/AS	86	42.5	12	22	36	64	26	13	26		M6	12	8.5	4.3	6	20	120	165
AG160	160/AS	116	56	15	31	46	85	33.5	11.5	36.5		M6	12	11	5.5	7	30	280	360
AG351	360/AS	122	72	25	32	45.5	90	33.5	30	36.5		M8	15	12	5.5	7	32	560	480
AG355	550/AS	164.5	75	18	42	55	122.5	41	15	35	41	M8	16	14	7	7	42	800	750
AG361	1100/AS	182	95	25	49	57	133	41	15	35	41	M10	18	16	8.5	8	50	1600	1060
AG371	2100/AS	238	118.5	35	61	70	177	50	35	50	50	M12	22	20	8.5	10	60	2500	2280
AG381	3100/AS	316	137	40	100	76	216	54	40	70	70	M14	25	22	11	10	100	4500	3350

