

VERTICAL SERIES



VERTICAL SERIES WITH STRAIGHT AND FRONT BASE

Material: Galvanized steel
Riveted pivots: Galvanized steel
Supporting bushes: Hardened and ground steel
Handles: Red polyurethane resistant to oils, grease and other chemical agents.
Performance: Form AVF with open clamping lever and two flanged washers. Form EVF with full clamping lever and bolt retainers to be welded in the desired position and angle.
Spindles: To be ordered separately (see Accessories on page 76).
Features and applications: During the closing, the clamping lever is guided laterally to ensure greater stability against possible transverse stresses. A special grease is placed between two contacting surfaces during assembly. This pneumatic actuated series is found on page 71.

FORM AVF

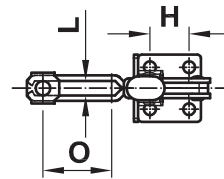
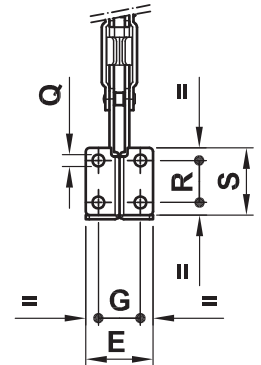
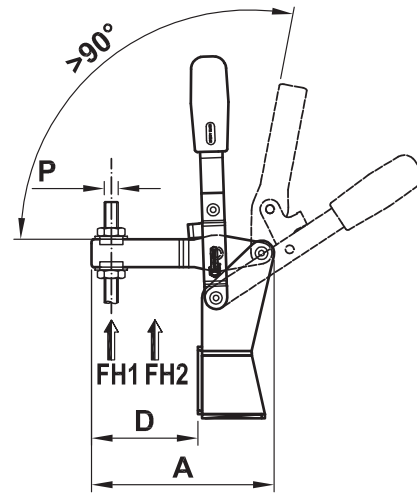

FORM EVF

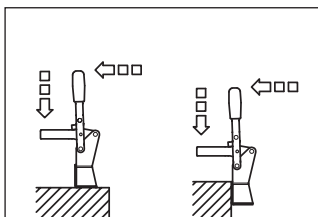
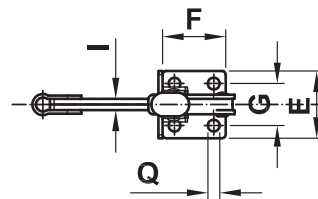
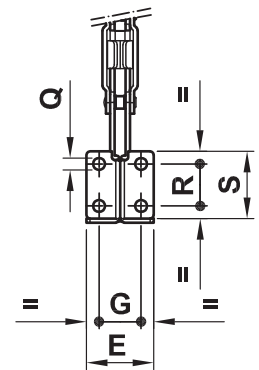
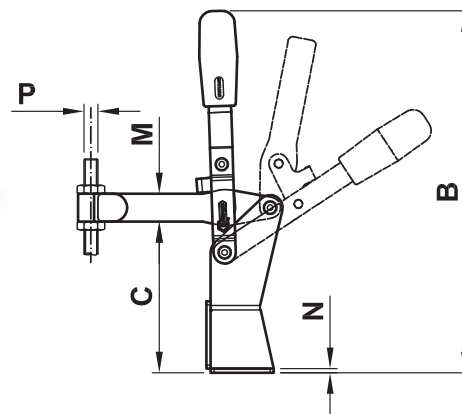

Code	Description	A	B	C	D	E	F	G	H	I	L	M	N	O	P	Q	R	S	Fh1 (daN)	Fh2 (daN)	gr.
AA221	200/AVF	103	203	77	59	38	32	26	16	8.5	17	3	36	M8	6.5	16	32	160	250	390	
AA226	200/EVF	105	203	77	61	38	32	26	16	6	17	3		M8	6.5	16	32	160	250	400	
AA321	300/AVF	130	258	108	76	48	45	30	28	10.3	20	3	50	M10	8.5	30	48	240	370	680	
AA326	300/EVF	132	258	108	77.5	48	45	30	28	8	20	3		M10	8.5	30	48	240	370	690	