

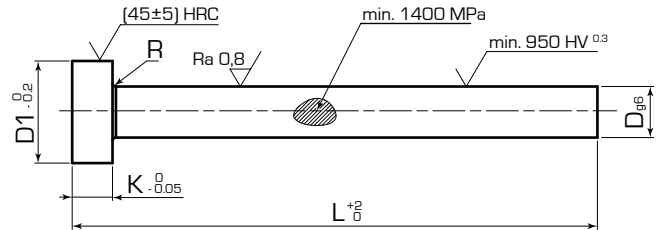

## R0101

Espulsore testa cilindrica nitruato DIN1530/ISO6751 - A  
Nitrided ejector pin cylindrical head DIN1530/ISO6751 - A



### Descrizione:

Materiale: 1.2344 Nitruato  
Temperatura max. di esercizio: 500/550 °C  
Rivestimento: DLC su richiesta  
Esempio di ordinativo: R0101-01-0001

### Description:

Material: 1.2344 Nitrided  
Max. work temperature: 500/550 °C  
Coating: DLC upon request.  
Example of purchasing order: R0101-01-0001

Codice Code	D	D1	K	R	L										
					100	125	160	200	250	315	400	500	630	800	1000
R0101-01	12.5	18	7	0.8	0290	0291	0292	0293	0294	0295	0296	0297	0298	0299	
R0101-01	14	22	7	0.8	0300	0301	0302	0303	0304	0305	0306	0307	0308	0309	0310
R0101-01	16	22	7	0.8	0311	0312	0313	0314	0315	0316	0317	0318	0319	0320	0321
R0101-01	18	24	7	0.8	0322	0323	0324	0325	0326	0327	0328	0329	0330	0331	0332
R0101-01	20	26	8	1		0333	0334	0335	0336	0337	0338	0339	0340	0341	0342
R0101-01	25	32	10	1			0343	0344	0345	0346	0347	0348	0349	0350	0351
R0101-01	32	40	10	1				0352	0353	0354	0355	0356	0357	0358	0359