

**rtc** TYPE 100

Cascade connector / UmlenkBuchse

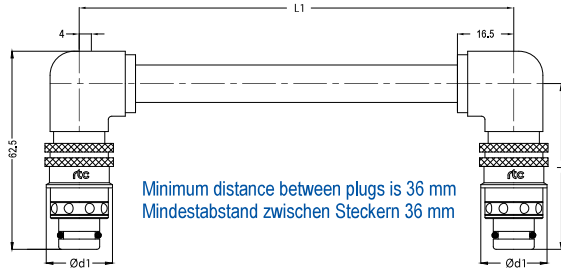

Plug / Stecker



Size Größe	Order No / Bestellnr. Without Valve / Ohne Ventil	Ød	Ød1	L	L1
08	100.08 PCF 125	11x1.5	20	54	125
	100.08 PCF 250	11x1.5	20	54	250
	100.08 PCF 500	11x1.5	20	54	500

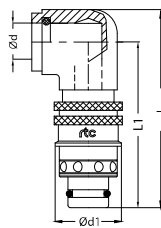

Size Größe	Order No / Bestellnr. Without Valve / Ohne Ventil	Ød	Ød1	L	L1
08	100.08 PCF 00	11x1.5	20	64	54

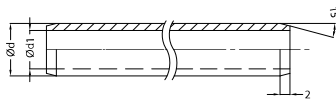

Pipe preparation / Verbindungsrohr

Brass Tube Messing Rohr	Ød	Ød1	Length Länge
TBM 1115x1000	11	8	1000mm

**rtc** TYPE 100

Male thread socket / Buchse mit Aussengewinde



Socket / Buchse

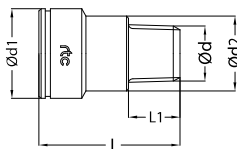

Body Size Größe	Order No / Bestellnr.	Ød	Ød1	Ød2	L	L1	INNER HEX.
06	100.06 SRF 10	BSPT 1/8	17	14	28.5	10	6
	100.06 SRF 13	BSPT 1/4	17	14	30.5	12	6
	100.06 STF 10	NPT 1/8	17	14	28.5	9	1/4"
	100.06 STF 13	NPT 1/4	17	-	28.5	11	1/4"
	100.06 SMF 1010	M10x1.0	17	14	28.5	10	6
08	100.08 SRF 10	BSPT 1/8	21	17.5	32	22	6
	100.08 SRF 13	BSPT 1/4	21	17.5	33	21	8
	100.08 SRF 17	BSPT 3/8	21	-	24	11	8
	100.08 STF 10	NPT 1/8	21	17.5	32	22	1/4"
	100.08 STF 13	NPT 1/4	21	17.5	33	21	5/16"
	100.08 STF 17	NPT 3/8	21	-	24	11	5/16"
	100.08 SMF 1010	M10x1.0	21	17.5	32	22	6
	100.08 SMF 1015	M10x1.5	21	17.5	32	22	6
100.08 SMF 1415	M14x1.5	21	17.5	32	21	6	
12	100.12 SRF 17	BSPT 3/8	32	25	41	28	10
	100.12 SRF 21	BSPT 1/2	32	25	44	28	14
	100.12 SRF 26	BSPT 3/4	32	-	32	13	14
	100.12 STF 17	NPT 3/8	32	25	41	28	3/8"
	100.12 STF 21	NPT 1/2	32	25	44	28	9/16"
	100.12 STF 26	NPT 3/4	32	-	32	13	9/16"